



Procon Engineering

(A Division of National Oilwell Varco UK Limited)



Type LP50 (DS1000) Compression Load Cell

Capacities 50, 100, 150, 200, 300 & 500 tonnes

IP65 Sealed

Low Profile

Stainless steel element

High temperature option to 100°C

The LP50 is a high capacity, low profile compression load cell, it can be used in force measurement and general weighing applications. For use in almost any industry, typical applications include: rolling mills, test rigs and heavy duty weighing.

Options available are:

- Plug & socket cable connection (recommended for 500Te load cells due to their size and weight to facilitate the safe handling and installation of the load cell).
- Custom build to customer's specifications.
- Cable length up to 25 metres maximum.

All Procon Engineering load cells come with a 3 year warranty.

Type LP50 (DS1000) Compression Load Cell

Technical Specification Sheet

SPECIFICATION			
		INDUSTRIAL	INDUSTRIAL
Standard capacities	tonnes	50 to 100	200 to 500
Accuracy class		0.5%	0.5% to 1%
Safe overload	x full capacity	1.5	1.5
Ultimate overload	x full capacity	3.0	3.0
Maximum safe side load	x full capacity	0.5	0.5
Deflection at rated capacity	mm	Typically <0.05 nom	Typically < 0.1 to 0.2 nom
Max excitation voltage	V	18	18
Rated output	mV/V	1.0 nom	2.0 nom
Zero balance	mV/V	± 0.02	± 0.04
Input resistance	ohms	190 ± 10	390 ± 20
Output resistance	ohms	175 ± 5	350 ± 5
Operating temperature range	°C	-20 to +80	-20 to +80
Compensated temperature range	°C	-10 to +50	-10 to +50
Cable length	m	5	5
Element body material		Stainless steel	Stainless steel
Environmental sealing		IP65	IP65

WIRING	
Red	Excitation positive
Blue	Excitation negative
Green	Output positive
Yellow	Output negative
Screen	Not connected to cell

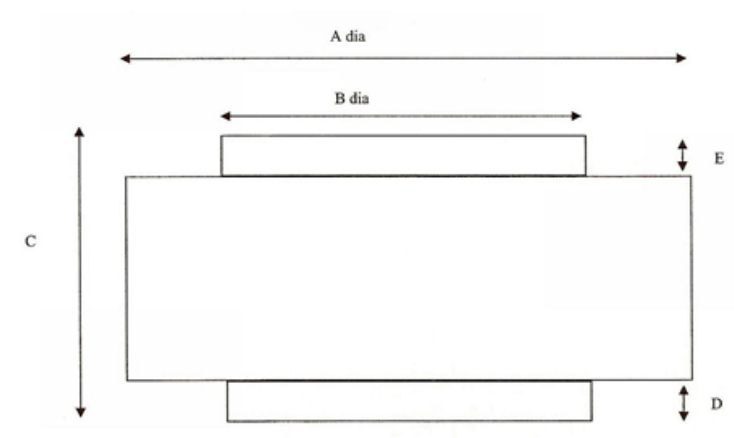

Capacity	A mm	B mm	C mm	D mm	E mm
50Te	100	60	75	4	4
100Te	152	98	89	9	13
200Te					
250Te	152	124	89	9	13
300Te					
500Te	182	150	150	3	5

Procon Engineering's policy is one of continuous product enhancement.

We therefore reserve the right to incorporate technical modifications without prior notification. E&OE.

Issue No: 2018-01

Block 4, Units 2 & 3
 Vestry Estate
 Sevenoaks, Kent, TN14 5EL

Tel: 01732 781300
 Fax: 01732 781311
 web site: www.proconeng.com

