

# Test Rods

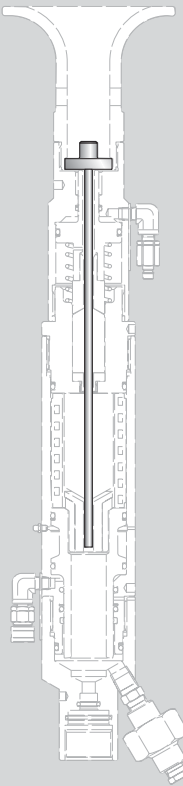

Test Rod for BOPs



Test Rod for Enviro™, Single and Dual Pack-Off shown with Enviro™

## BOPS

Part Number	Wire Size	Overall (mm)	X-Bar (mm)	Load Test (Kg)	Equipment Size
L-974956	3/16"	1,265	200	500	6 3/8" 10K & 5 1/8" 15K TEC
L-973440	7/32"	1,265	200	500	6 3/8" 10K & 5 1/8" 15K TEC
L-9701004629	7/32"	1,405	200	500	Special
L-9701007264	7/32"	1,405	270	500	9" SSR
L-9701020031	7/32"	1,568	200	500	Special
L-9701006370	1/4"	1,265	200	650	6 3/8" 10K & 5 1/8" 15K TEC
L-980551	9/32" (0.281")	1,265	200	1,000	6 3/8" 10K & 5 1/8" 15K TEC
L-974957	5/16"	1,265	200	1,000	6 3/8" 10K & 5 1/8" 15K TEC
L-972775	3/8"	1,265	200	1,000	6 3/8" 10K & 5 1/8" 15K TEC
L-973114	0.390"	1,265	200	1,000	6 3/8" 10K & 5 1/8" 15K TEC
L-974959	7/16" (0.437")	1,265	200	1,000	6 3/8" 10K & 5 1/8" 15K TEC
L-974958	15/32" (0.468")	1,265	200	1,000	6 3/8" 10K & 5 1/8" 15K TEC
L-9701022607	0.468"	1,442	200	1,000	HLW-B & NRS BOP
L-981256	1/2"	1,265	200	1,000	6 3/8" 10K & 5 1/8" 15K TEC
L-9701022608	0.500"	1,442	200	1,000	HLW-B & NRS BOP

## BOP-V

Part Number	Wire Size	Overall (mm)	X-Bar (mm)	Load Test (Kg)
L-970838	15/32"	720	200	1,000
L-9701011702	7/32"	720	200	1,000
L-982077	7/16"	720	200	1,000

## BOP-D

Part Number	Wire Size	Overall (mm)	X-Bar (mm)	Load Test (Kg)
L-982247	15/32"	1,015	200	1,000

## ENVIRO™

Part Number	Wire Size	Overall (mm)	X-Bar (mm)	Load Test (Kg)
L-972242	3/16" & 15/32"	NA	NA	NA
L-9701007407	7/32" & 5/16"	NA	NA	NA
L-9701007408	0.230" & 0.390"	NA	NA	NA

## SINGLE PACK-OFF

Part Number	Wire Size	Overall (mm)	X-Bar (mm)	Load Test (Kg)
L-980712	3/16" & 15/32"	NA	NA	NA

## DUAL PACK-OFF

Part Number	Wire Size	Overall (mm)	X-Bar (mm)	Load Test (Kg)
L-973431	3/16" & 15/32"	NA	NA	NA
L-9701021667	1/2"	NA	NA	NA